

© COPYRIGHT 2022 BY INDUSTRIAL FIBER OPTICS, INC.
ALL RIGHTS RESERVED.

LENGTH	TOLERANCE
0.1m	+0.03;-0.0m
0.2-0.99m	± 0.03m
1-5.49m	± 0.05m
5.5-12.99m	± 0.1m
13-29.99m	± 0.15m
30-50m	± 0.3m
50.1 - 80	± 0.5m

SERIES	FIBER*
IF 1N1N	TCF-1000 GHCP4001
IF 1N1L	TC-1000 GH4001
IF 1N1M	TCV-1000 GHV4001
IF 1N1O	GHN4001
IF 1N1Q	GHTT4001
IF 1N1V	BH4001 SHCN-1000(E)
IF 1N1D	DC-1000 SH4001
IF 1N1Y	LH4001-N

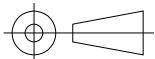

METRIC

REVISIONS

REV	DESCRIPTION	ECO	DATE	DWN	APVD
A	Initial Release		6/27/2019	DDH	
B	Replaced TCU-1000(L) with TCU-1000	00381	09/28/20	DDH	
C	Added note regarding material substitution, removed IF 3L18	00417	8/15/2022	BB	DDH

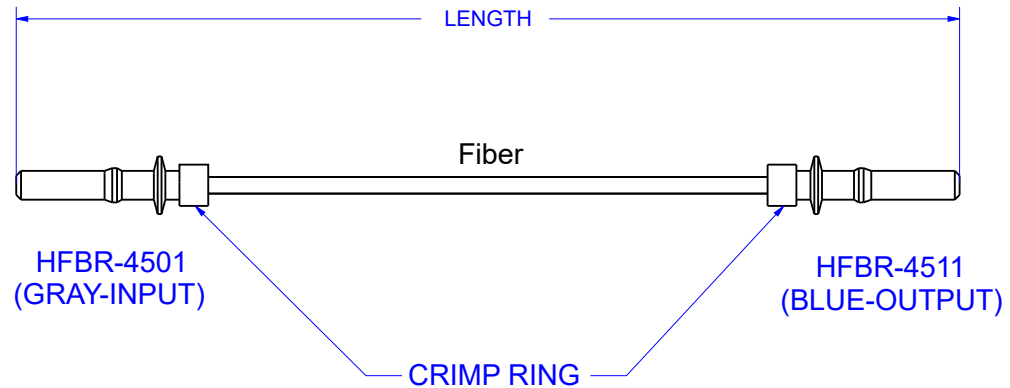

*The fiber cable used for the assembly will be based upon the category of cable used for the SERIES. Asahi Kasei and Mitsubishi Eska optical fiber cable are shown, however other manufacturers' cable may be used based on availability.

UNLESS OTHERWISE SPECIFIED DIMENSIONS MILLIMETERS [IN.]	PRODUCT	Industrial Fiber Optics TEMPE, AZ 85281			
	MATERIAL				
DIMENSIONS ARE FOR REFERENCE ONLY NO TOLERANCES MAY BE IMPLIED FROM THIS DOCUMENT	FINISH	NONE	NAME		
	DRAWN BY	David Hanson	Simplex Non-Latching Versatile Link Cable Assembly		
	DATE	6/27/2019	SIZE	SCALE	DOCUMENT NUMBER
	CHECKED BY	B. Bidwell	A	1:2	IF 1N1x
	DATE	9/28/2020	DO NOT SCALE DRAWING		REV C
				1 OF 1	