

© COPYRIGHT 2022 BY INDUSTRIAL FIBER OPTICS, INC.
ALL RIGHTS RESERVED.

REVISIONS

REV	DESCRIPTION	ECO	DATE	DWN	APVD
00	Initial Release		6/04/2019	DDH	
A	Add information tables		6/26/2019	DDH	
B	Added note regarding material substitution	00417	8/15/2022	BB	DDH

LENGTH	TOLERANCE
0.1m	+0.03;-0.0m
0.2-0.99m	± 0.03m
1-5.49m	± 0.05m
5.5-12.99m	± 0.1m
13-29.99m	± 0.15m
30-50m	± 0.3m
50.1 - 80	± 0.5m

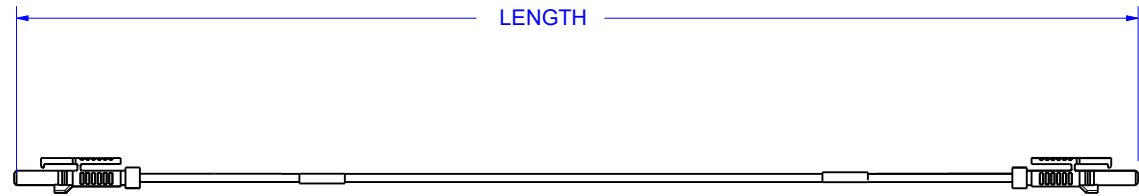

CROSSOVER
SIMPLEX LATCHING

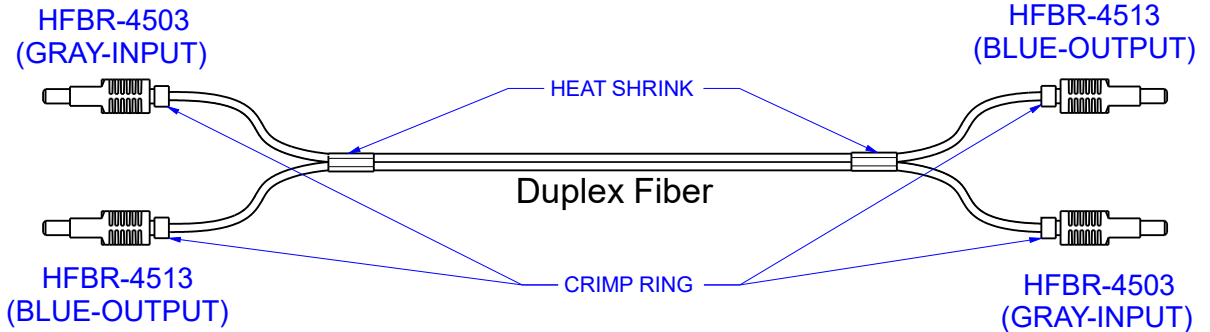

*The fiber cable used for the assembly will be based upon the category of cable used for the SERIES. Asahi Kasei and Mitsubishi Eska optical fiber cable are shown, however other manufacturers' cable may be used based on availability.

SERIES	FIBER*
IF 1L3L	TC-1000W GH4002
IF 1L3M	TCV-1000W GHV4002
IF 1L3N	TCF-1000W GHCP4002
IF 1L3Q	GHTT4002
IF 1L3D	DC-1000W SH4002

UNLESS OTHERWISE SPECIFIED DIMENSIONS MILLIMETERS [IN.]	PRODUCT	Industrial Fiber Optics TEMPE, AZ 85281			
	MATERIAL				
DIMENSIONS ARE FOR REFERENCE ONLY NO TOLERANCES MAY BE IMPLIED FROM THIS DOCUMENT	FINISH	NONE	NAME Simplex Latching Versatile Link Duplex Fiber Cable Assembly		
	DRAWN BY	David Hanson	SIZE	SCALE	DOCUMENT NUMBER
	DATE	6/4/2019	A	1:2	IF 1L3x
	CHECKED BY	B. Bidwell			REV
	DATE	8/15/2022	DO NOT SCALE DRAWING		B
				1 OF 1	

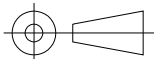

METRIC