

© COPYRIGHT 2022 BY INDUSTRIAL FIBER OPTICS, INC.  
ALL RIGHTS RESERVED.

REVISIONS

REV	DESCRIPTION	ECO	DATE	DWN	APVD
A	Initial Release	00354	09/19/19	DDH	
B	Added note regarding material substitution	00417	8/15/2022	BB	DDH

LENGTH	TOLERANCE
0.1m	+0.03;-0.0m
0.2-0.99m	± 0.03m
1-5.49m	± 0.05m
5.5-12.99m	± 0.1m
13-29.99m	± 0.15m
30-50m	± 0.3m
50.1 - 80	± 0.5m

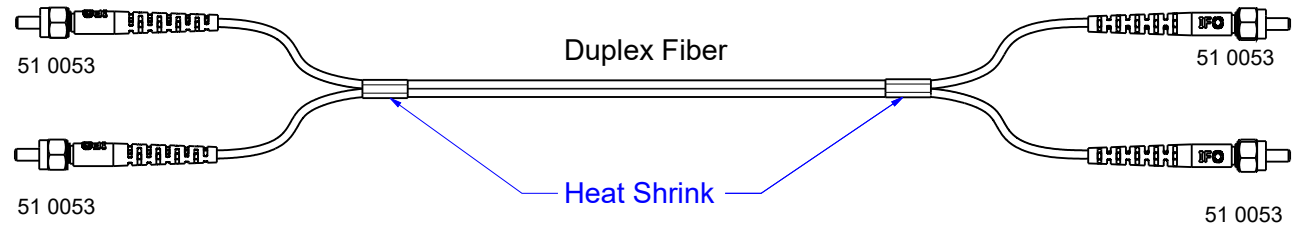
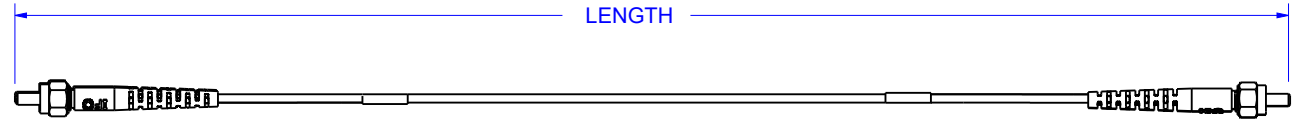

\*The fiber cable used for the assembly will be based upon the category of cable used for the SERIES. Asahi Kasei and Mitsubishi Eska optical fiber cable are shown, however other manufacturers' cable may be used based on availability.

SERIES	FIBER*
IF 112D	DC-1000W SH4002
IF 112L	TC-1000W GH4002
IF 112M	TCV-1000W GHV4002
IF 112N	TCF-1000W GHCP4002
IF 112Q	GHTT4002
IF 112W	GHEL4002-OR

UNLESS OTHERWISE SPECIFIED DIMENSIONS MILLIMETERS [IN.]	PRODUCT	Industrial Fiber Optics TEMPE, AZ 85281			
	MATERIAL				
DIMENSIONS ARE FOR REFERENCE ONLY NO TOLERANCES MAY BE IMPLIED FROM THIS DOCUMENT	FINISH	NONE	NAME		
	DRAWN BY	David Hanson	SMA Duplex POF Cable Assembly		
	DATE	9/20/2019	SIZE	SCALE	DOCUMENT NUMBER
	CHECKED BY	B. Bidwell	A	1:1	IF 112x
	DATE	9/27/2019	DO NOT SCALE DRAWING		REV B
				1 OF 1	

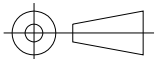

**METRIC**