

© COPYRIGHT 2022 BY INDUSTRIAL FIBER OPTICS, INC.  
ALL RIGHTS RESERVED.

REVISIONS

REV	DESCRIPTION	ECO	DATE	DWN	APVD
A	Initial Release	00354	11/25/2019	DDH	BB
B	Added note regarding material substitution	00417	8/15/2022	BB	DDH

LENGTH	TOLERANCE
0.1m	+0.03;-0.0m
0.2-0.99m	± 0.03m
1-5.49m	± 0.05m
5.5-12.99m	± 0.1m
13-29.99m	± 0.15m
30-50m	± 0.3m
50.1 - 80	± 0.5m

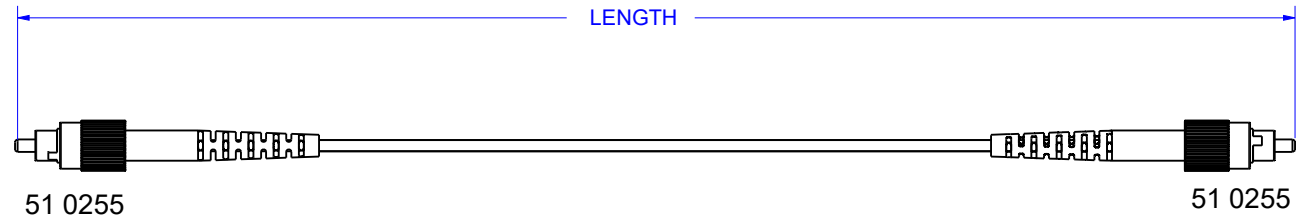

SERIES	FIBER*
IF 181N	TCF-1000 GHCP4001
IF 181L	TC-1000 GH4001
IF 181M	TCV-1000 GHV4001
IF 181O	GHN4001
IF 181Q	GHTT4001
IF 181V	BH4001 SHCN-1000(E)
IF 181D	DC-1000 SH4001

\*The fiber cable used for the assembly will be based upon the category of cable used for the SERIES. Asahi Kasei and Mitsubishi Eska optical fiber cable are shown, however other manufacturers' cable may be used based on availability.

UNLESS OTHERWISE SPECIFIED DIMENSIONS MILLIMETERS [IN.]	PRODUCT	Industrial Fiber Optics TEMPE, AZ 85281			
	MATERIAL				
DIMENSIONS ARE FOR REFERENCE ONLY NO TOLERANCES MAY BE IMPLIED FROM THIS DOCUMENT	FINISH	NONE	NAME		
	DRAWN BY	David Hanson	FC Simplex Cable Assembly		
	DATE	11/25/2019	SIZE	SCALE	DOCUMENT NUMBER
	CHECKED BY	B. Bidwell	A	1:1	IF 181x
	DATE	11/25/2019	DO NOT SCALE DRAWING		REV B
				1 OF 1	

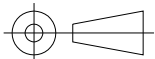

**METRIC**