

4

3

2

1

(C) COPYRIGHT 2019 BY INDUSTRIAL FIBER OPTICS, INC.
ALL RIGHTS RESERVED

INSTRUCTIONS:

- 1) SLIP BOOT OVER CABLE JACKET.
- 2) STRIP 16mm OF OUTER TUBE FROM END OF CABLE.
- 3) STRIP 7.7mm OF BUFFER FROM END OF OPTICAL FIBER.
- 4) APPLY EPOXY TO INSIDE OF CONNECTOR USING A SYRINGE.
- 5) INSERT FIBER INTO FERRULE.
- 6) SLIP BOOT DOWN OVER CONNECTOR.
- 7) CLEAVE AND POLISH AFTER EPOXY HAS CURED FULLY.

NOTES:

- 1) RoHS COMPLIANT.
- 2) -40°C TO +85°C OPERATING TEMPERATURE.
- 3) SUITABLE FOR MULTIMODE FIBER WITH 2mm OUTSIDE DIAMETER.
- 4) IEC 61754-22 COMPATIBLE.
- 5) STAINLESS STEEL FERRULE AND NUT.
- 6) DUST CAP.
- 7) MAXIMUM NUT TORQUE: 0.9n-m [8 in-lbs].

REVISIONS

REV.	DESCRIPTION	ECO	DATE	DWN	APVD
00	Prerelease		8/27/2019	BB	
A	Initial Release, no changes		9/3/2019	BB	DH
B	Updated bore diameter, bore diameter tolerances, and concentricity	00442	9/1/2023	SA	BB

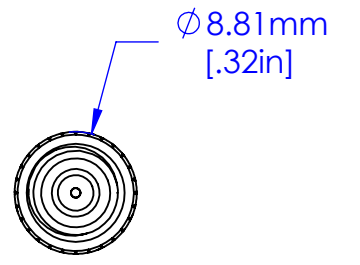
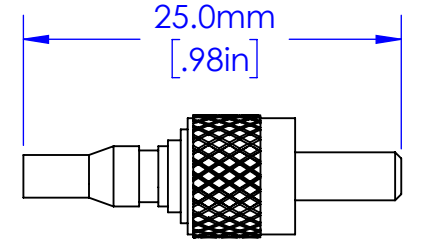
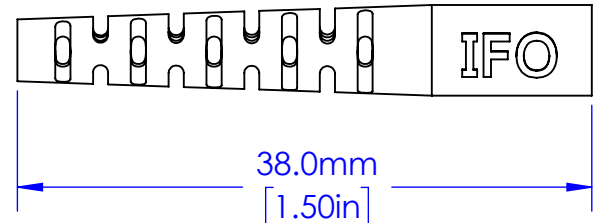
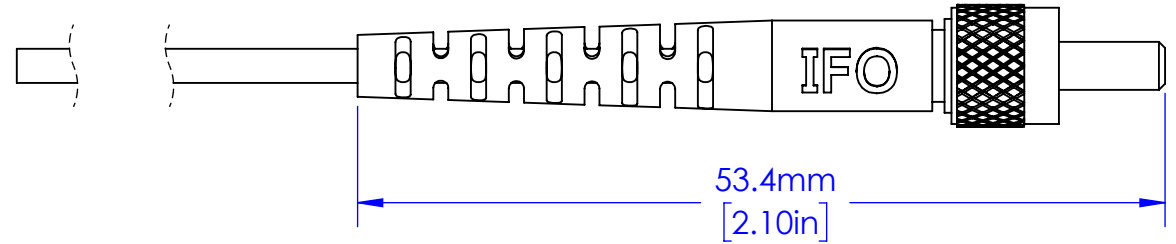
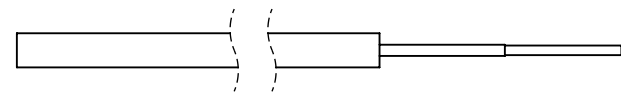
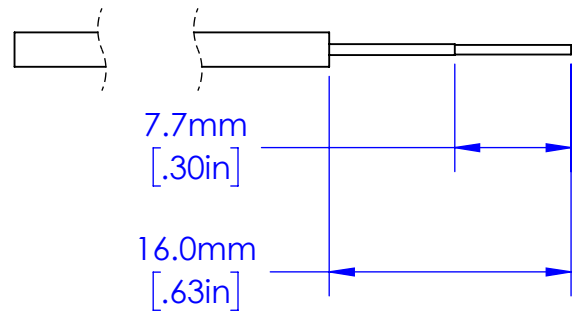

Part ID	Hole Ø(µm)	Hole ◎(µm)
51 0540	635 +15/-0	15
51 0541	835 +15/-0	15

PROPRIETARY AND CONFIDENTIAL
THE INFORMATION CONTAINED IN THIS DRAWING IS THE SOLE PROPERTY OF INDUSTRIAL FIBER OPTICS. ANY REPRODUCTION IN PART OR AS A WHOLE WITHOUT THE WRITTEN PERMISSION OF INDUSTRIAL FIBER OPTICS IS PROHIBITED.

DIMENSIONS	MILLIMETERS [IN]	UNLESS OTHERWISE SPECIFIED:
0 PLC:	±1.0	Customer:
1 PLC:	±0.3	
2 PLC:	±0.13	
3 PLC:	±0.025	INTERPRET GEOMETRIC TOLERANCING PER:ASME Y14.5-2009
4 PLC:	±0.0127	MATERIAL
ANGLE:	±1/2	FINISH
APPLICATION		DO NOT SCALE DRAWING

INDUSTRIAL FIBER OPTICS
TEMPE, AZ 85281

TITLE:
2mm Loose Tube SMA

SIZE DWG. NO. REV
B

SCALE: 1:2 WEIGHT: SHEET 1 OF 1

4

3

2

1